



Accessories

RF built-in antenna SMA G-ST 0.2 m - NET

Material no.: 1212351

Product features

- RF built-in antenna with straight SMA plug-in connector
- Suitable for SW868 and SW922

Dimensions

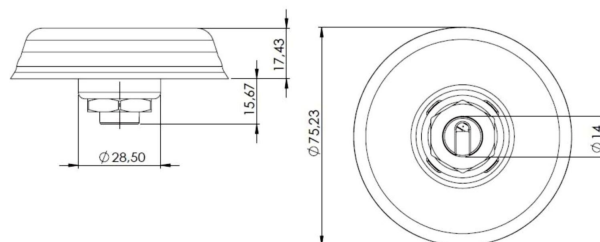

Technical data

Cover

ABS, black

Sealing

TPE

Degree of protection

IP67 (IEC/EN 60529)

Connection

cable

Cable

RG174

Cable length

0.2 m

Connector

SMA (male)

Dimensions

77.4 x 15.9 mm (dimensions after mounting)

Ambient temperature

-40 °C ... +85 °C

Frequency range

824 - 960 MHz

1.8 GHz / 1.9 GHz

2.1 GHz / 2.4 GHz

Impedance

50 Ω

Polarization

linear

Gain

2.2 dBi

VSWR

<2.6:1

Note

Antenna gain depends on size of the metal plate.

Stated SWR refers to a measurement of 2.5 m RG174 on 50x50 cm metal plate.

Weight

116 g

Arrangement of receiver and switch antenna



A = Optimum mounting

B = Possible mounting

C = Unsuitable mounting

Errors and omissions excepted.