



## Accessories

### RF built-in antenna R-SMA G-ST 3 m - NET

Material no.: 1291911

#### Product features

- RF built-in antenna with straight RSMA plug-in connector
- Suitable for SW915 and SW917

#### Dimensions

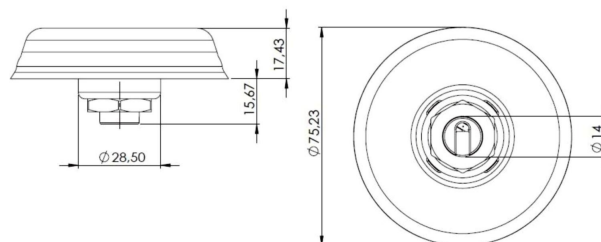

#### Technical data

##### Cover

ABS, black

##### Sealing

TPE

##### Degree of protection

IP67 (IEC/EN 60529)

##### Connection

cable

##### Cable

RG174

##### Cable length

3 m

##### Connector

R-SMA (male)

##### Dimensions

77.4 x 15.9 mm (dimensions after mounting)

##### Ambient temperature

-40 °C ... +85 °C

##### Frequency range

824 - 960 MHz

1.8 GHz / 1.9 GHz

2.1 GHz / 2.4 GHz

##### Impedance

50  $\Omega$

##### Polarization

linear

##### Gain

2.2 dBi

##### VSWR

<2.6:1

##### Note

Antenna gain depends on size of the metal plate.

Stated SWR refers to a measurement of 2.5 m RG174 on 50x50 cm metal plate.

#### Arrangement of receiver and switch antenna



A = Optimum mounting

B = Possible mounting

C = Unsuitable mounting

Errors and omissions excepted.